

**THE COUNCIL OF THE BOROUGH OF MILTON KEYNES (THE COUNCIL OF  
THE BOROUGH OF MILTON KEYNES (VARIOUS ROADS, NEATH HILL) (PROHIBITION  
AND RESTRICTION OF WAITING) ORDER 2012) VARIATION ORDER 2013**

The Council of the Borough of Milton Keynes ("the Council") in exercise of its powers under Sections 1(1) and 2(1) and (2), 4(2) and Part IV of Schedule 9 of the Road Traffic Regulation Act 1984 ("the Act of 1984") and of all other enabling powers, and after consultation with the chief officer of police in accordance with Part III of Schedule 9 to the Act of 1984, hereby makes the following Order:-

**PART 1**

**IMPLEMENTATION AND CITATION**

1. This Order shall come into operation on the 28<sup>th</sup> day of March 2013 and may be cited as "The Council of the Borough of Milton Keynes (The Council of the Borough of Milton Keynes (Various Roads, Neath Hill) (Prohibition and Restriction of Waiting) Order 2012) Variation Order 2013".
2. Any reference in this Order to any enactment shall be construed as a reference to that enactment as amended by any subsequent enactment.
3. The plan annexed to this Order identifies the lengths of roads subject to this Order, provided that where there is any inconsistency between the plan and the Articles it is the wording of the Articles which shall prevail.
4. The plan annexed to this Order is hereby annexed to The Council of the Borough of Milton Keynes (Various Roads, Neath Hill) (Prohibition and Restriction of Waiting) Order 2012 and forms part of that Order.

**PART 2**

**VARIATIONS**

5. The Council of the Borough of Milton Keynes (Various Roads, Neath Hill) (Prohibition and Restriction of Waiting) Order 2012 ("The Principal Order") is varied as provided by the following provisions of this Order:-
6. Item LW2 in Schedule 2 of the Principle Order is hereby varied to the extent stated below;

**CURRIER DRIVE – SOUTH-EAST SIDE**

LW2 From a point approximately 91.2 metres north-east of the centreline of the junction with Tower Drive and continuing for a distance of approximately 8.6 metres in a north-easterly direction.

THE COMMON SEAL of the  
**COUNCIL OF THE BOROUGH OF  
MILTON KEYNES** was hereunto affixed  
this 27<sup>th</sup> day of March 2013  
in the presence of:-

.....  
ACTING ASSISTANT DIRECTOR – LAW & GOVERNANCE



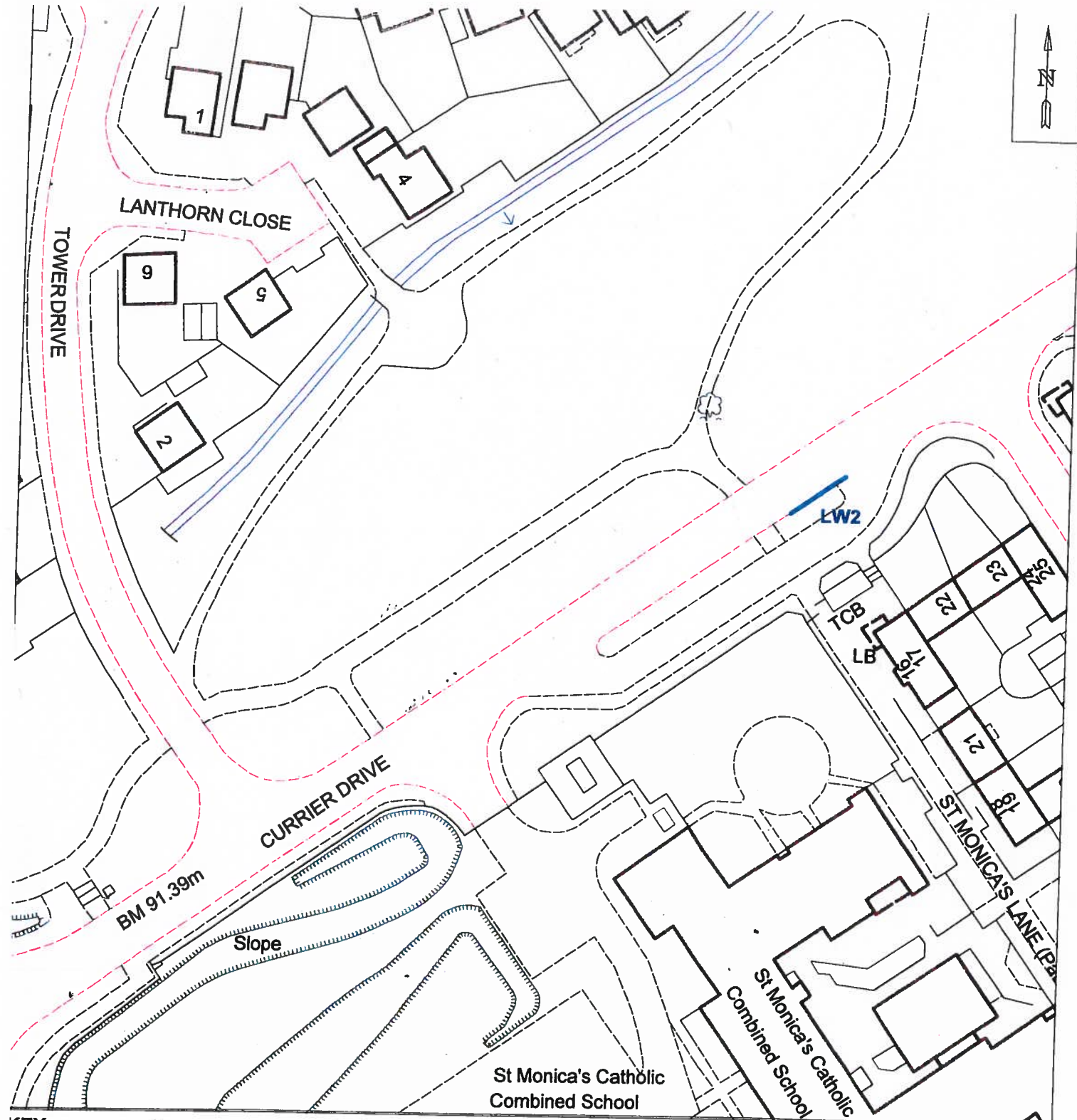

**KEY:**

— Waiting limited to 15 minutes, No return within 1 hour

**LW2** TRO Reference Number

Map referred to in The Council of the Borough of Milton Keynes (The Council of the Borough of Milton Keynes (Various Roads, Neath Hill) (Prohibition and Restriction of Waiting) Order 2012) Variation Order 2013

Not to scale

The common seal of the Council of the Borough of Milton Keynes was hereunto affixed in the presence of:

*[Handwritten signature]*



ACTING ASSISTANT DIRECTOR – LAW & GOVERNANCE